

Using the SATO DuraMark™ Wristband and Failsafe Fastener™

Remove the printed wristband

- After printing remove the wristband and carrier from the printer
- Separate this from the D500 Series printer by a gentle pull – left to right in an upward motion

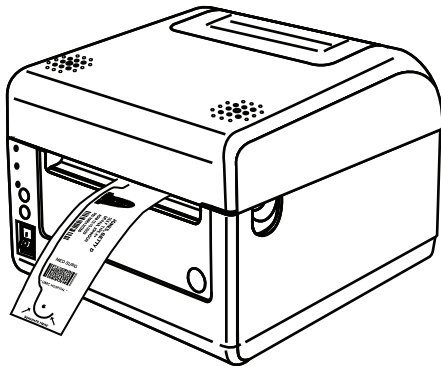

Preparing the wristband for use

- Remove the wristband from the carrier by lifting the locking hole side of the wristband
- Pull apart the wristband from the carrier
- Discard the carrier

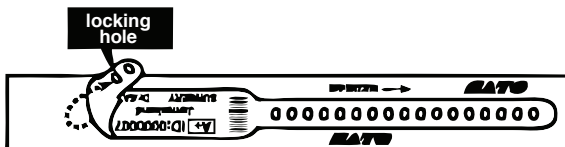

- Attached the Failsafe Fastener™ to the wristband by inserting the two locking pins into the locking holes

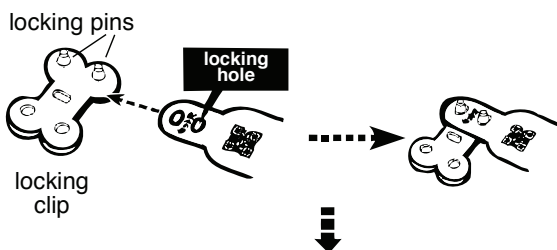

The prepared wristband will look like this:

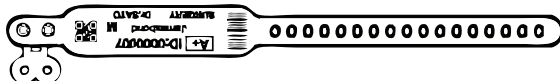

Attaching the wristband

- Wrap the wristband around the patient's wrist
- Leave a comfortable amount of slack to allow unrestricted movement by the patient
- If possible, avoid attaching the wristband near areas affected by skin ailments such as a rash
- Do not over-tighten a wristband as it may cause the patient discomfort
- Now press the appropriate locking holes of the wristband onto the locking two pins

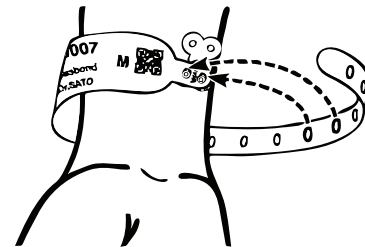

Locking the wristband

- Make sure the wristband cannot slip off the patient's hand
- Now lock the wristband with the locking clip by snapping the clip shut

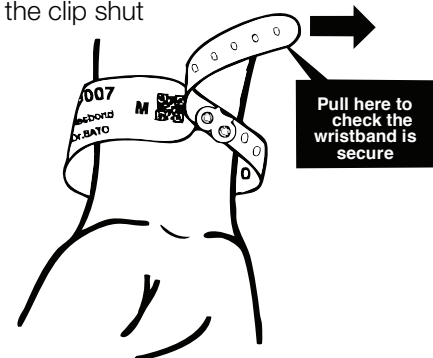

- Cut off the extra length of the wristband

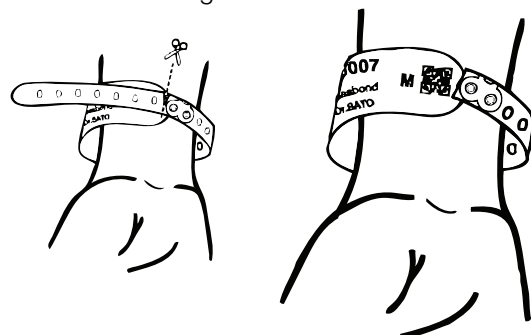

Do not attempt to reopen or reuse the locked failsafe fastener once it has been securely closed.